

REAL KITCHENS PLANNING TRENDS SHOPPING EXPERT ADVICE

BEAUTIFUL KITCHENS

FIND YOUR
Dream.
18 kitchens
to inspire
design

STYLISH
STORAGE
SOLUTIONS

KITCHEN LARDERS
TO SUIT EVERY
SCHEME

**BEST
BUYS**

- STEAM OVENS
- PENDANT LIGHTING
- LATEST RANGES

WOODEN WORKTOPS

Top off your design with a natural beauty

Nov
2009
£3.99

US\$8.50/
AUS\$10.75/
NZ\$13.25

RECALL DATE 29/10/09



THE ONLY MONTHLY MAGAZINE DEDICATED TO KITCHENS

Viki and Mike chose vibrant hi-gloss Alno units from Halcyon Interiors for their newly extended room in shades of Coral and Cocoa. 'Our friends like the unusual colours, especially as most people opt for light cabinetry,' explains Viki. The walls are finished in Dulux's Brilliant White for an airy feel

Stunning cocoa and tangerine-cabinetry in a smart glossy finish ensures the Clarkes' large kitchen-diner is a truly delicious design

CHOCOLATE ORANGE

My top tip...
is to make a scrapbook filled with things you like and keep details of the appliances, swatches of materials and paint colours you used. This way, there is a record if anything needs updating?

VIKI CLARKE



LEFT Viki chose to pair her induction hob with a retractable downdraft extractor from Wolf. 'Fitting a large ceiling-mounted hood over the island would have compromised the design of the room,' she explains.

BELOW 'Although it's not the most practical work surface when my nieces visit, as it gets covered in fingerprints within five minutes, the stainless steel is extremely stylish and hygienic, plus any scratches add to the professional feel,' smiles Viki.

For most people, the process of finding a home is nothing short of a quest for perfection. But then Viki Clarke, a graphic designer with a keen eye for style, isn't like most people. 'I wanted a project I could get my teeth into,' she says. 'My husband Mike and I just didn't see the point of paying a premium for a property renovated to somebody else's tastes.'

So when a neglected period terrace came up for sale in south-west London, Viki couldn't wait to take Mike along for a look. 'The house had been split into bedsits, with a main living area on the ground floor,' she recalls. 'It had a 1970s decor and the kitchen was very small and outdated. I knew it would be ideal.'

Viki had always dreamt of having a large kitchen-diner big enough to entertain her friends, so opted to extend the existing space into the adjacent side return. 'Mike and I love cooking but we'd never been able to have more than two guests over for dinner in our last place because we didn't have the room,' she explains. 'We prefer the informality of eating in the kitchen, so we dismissed the idea of creating a separate dining area.'

As the structural work went ahead, project-managed by Phil Rogerson of MPS Design, Viki started researching styles of units and worktops. 'I decided I wanted stainless-steel worksurfaces after seeing a celebrity chef's kitchen. It was the first time I'd seen a scheme that took the professional into the residential,' recalls Viki. The stunning steel surfaces were then paired with hi-gloss Alno units from Halcyon Interiors. 'I'd seen a maroon-coloured design elsewhere but as it didn't offer the vibrancy I was after, Phil suggested I try Alno,' remembers Viki.

The Coral shade was exactly what she'd had in mind. 'I was convinced as soon as I saw the design on Alno's website and again when I went to Halcyon Interiors and met up with designer Andrea Mueller,' she continues. 'I only wavered just before the installation but once the units were fitted, I was thrilled.'

Viki and Mike's efficient appliances that are built in to a bank of contrasting Chocolate units make light work of their dinner-party preparations. 'We recently cooked for 16 people, which was quite amazing, especially as we're more used to catering for groups of two or four,' enthuses Viki. 'We put the dining and garden tables end to end and everyone ate beneath the glass roof of the extension, under the stars. It was lovely,' she smiles.



RIGHT Deep island drawers are mounted on soft-close runners and provide an efficient storage space for Viki to keep her pots and pans. The long bar handles from Alno are finished in stainless steel and match the room's other metallic elements, such as the smart worksurfaces.

Bronzo floor tiles from European Heritage's Steelwork range coordinate with the chunky worktops and continue outside to add to the feeling of openness. 'They are also very practical with our dog, Emma,' says Viki.



To avoid a double run of units being interrupted by door furniture, Viki opted for handleless wall cabinetry fitted with integral downlighters, which provide task lighting on the surface below. The Coral base units hide many of the couple's appliances, including a freezer, dishwasher and a washer dryer, for a more streamlined look. The aluminium plinths supplied by Alno give the impression that the glossy cabinetry is floating



I wish... I'd known to install LEDs instead of halogen bulbs into the floor. One of my dog Emma's toys was left on a light and melted over it. We were lucky the whole kitchen didn't go up in flames!

ABOVE CENTRE A two-bowl sink with integral drainer has been incorporated into the stainless-steel worktop supplied by Blanco. At the centre of the stylish wet area, a Voxo monobloc mixer tap from Abode easily controls the flow of water. At first glance, its smart handleless design appears unfinished but the water is actually released with a simple twist of the central block

ABOVE RIGHT "We enjoy cooking so much more since we've had the new kitchen installed," explains Viki. "Whether we have just a couple of close friends over for an intimate gathering or lots of people for a large get-together, everyone always congregates here"

RIGHT Viki and Mike received the Emu Veranda garden dining chairs from John Lewis as a wedding present and then bought the Emu Piano table to match. "To create more space for our guests, I designed the L-shaped bench around the table and had some cushions made up by The Paint House," recalls Viki. To prevent the space from looking too urban, Viki asked project manager Phil to build a patio planter and bought some evergreen shrubs from World's End Nurseries to add a natural element





LEFT A pop-up bank of electrical sockets by Evoline is perfect for plugging in freestanding appliances when they are needed. After use, the unit discreetly retracts back into the surface. The stainless-steel splashback came from Halcyon Interiors

The Thor extendable dining table and Hans chairs are from Ligne Roset, while the Tekne radiators came from MHS. 'Every piece I chose had to be interesting,' says Viki, who wanted her kitchen to be as individual as possible. A flatscreen TV is positioned on an exposed brick wall in the extension, so Viki and Mike can continue watching it as they are preparing meals. L2i supplied the glass roof and glazed doors, which add a conservatory-style feel to the open-plan dining area



DESIGN & CABINETRY

- Viki Clarke with Phil Rogerson at **MPS Design** and Andrea Mueller at **Halcyon Interiors**. The Alno Store, 120 Wigmore Street, London W1U 3LS (020 7486 3080) www.halcyon-interiors.co.uk
- Coral hi-gloss cabinetry and Cocoa hi-gloss units, both from the AlnoLux range by Alno

WORKTOPS

- Steel Art stainless steel, Blanco **POA**

SINK & TAP

- One-and-a-half-bowl sink, as integral part of worksurface
- AT1106 Vixio monobloc mixer tap in stainless steel, Abode **£176**
- ISE65 waste disposal unit, In-Sink-Erator **£374**

APPLIANCES (shown)

- H5681 built-in single pyrolytic oven, Miele **£1,926**
- H5080 built-in combination oven, Miele **£1,930**
- KM5993 five-zone induction hob, Miele **£1,888**
- DD361 downdraft extractor, Wolf **£1,977**
- ESW5080-29 built-in warming drawer, Miele **£708**

APPLIANCES (not shown)

- Fully integrated larder fridge, Siemens **£869**
- Fully integrated undercounter freezer, Siemens **£369**
- Fully integrated dishwasher, Miele **£1,311**
- Fully integrated washer dryer, Siemens **£977**

☎ For stockists, see page 152

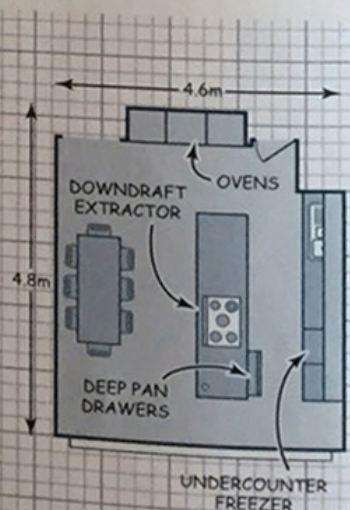

GUIDE PRICE

- Starting price for a Halcyon Interiors kitchen **£18,000**